

## Calibration steering angle sensor

**⚠ Warning:** The vehicle's front wheels may be deflected automatically during the calibration procedure.

Risk of injury and death! Material damage is possible.

Ensure that there are no people present in the area around the steering system during calibration.

**Note:** Calibration of the steering angle sensor and steering valve is required if:

- the E-BOX has been replaced
- the steering angle sensor has been replaced

**Note:** Calibration of the steering angle sensor and steering valve may be required if:

- the vehicle is oscillating on the wayline or catches up the wayline very slowly
- other steering problems occur

**Note:** If the vehicle is oscillating on the wayline or catches up the wayline very slowly there may be several reasons, e.g.:

- IMU calibration required
- Steering valve calibration required
- Steering angle sensor calibration required (front wheels must be in exact straight-ahead position when required during calibration)
- Steering settings, see → Settings → Steering
- Implement settings (see → manual of the implement)
- Front axle ballast
- Lower link stabilization setting
- Significant difference in tire pressure between left and right tires



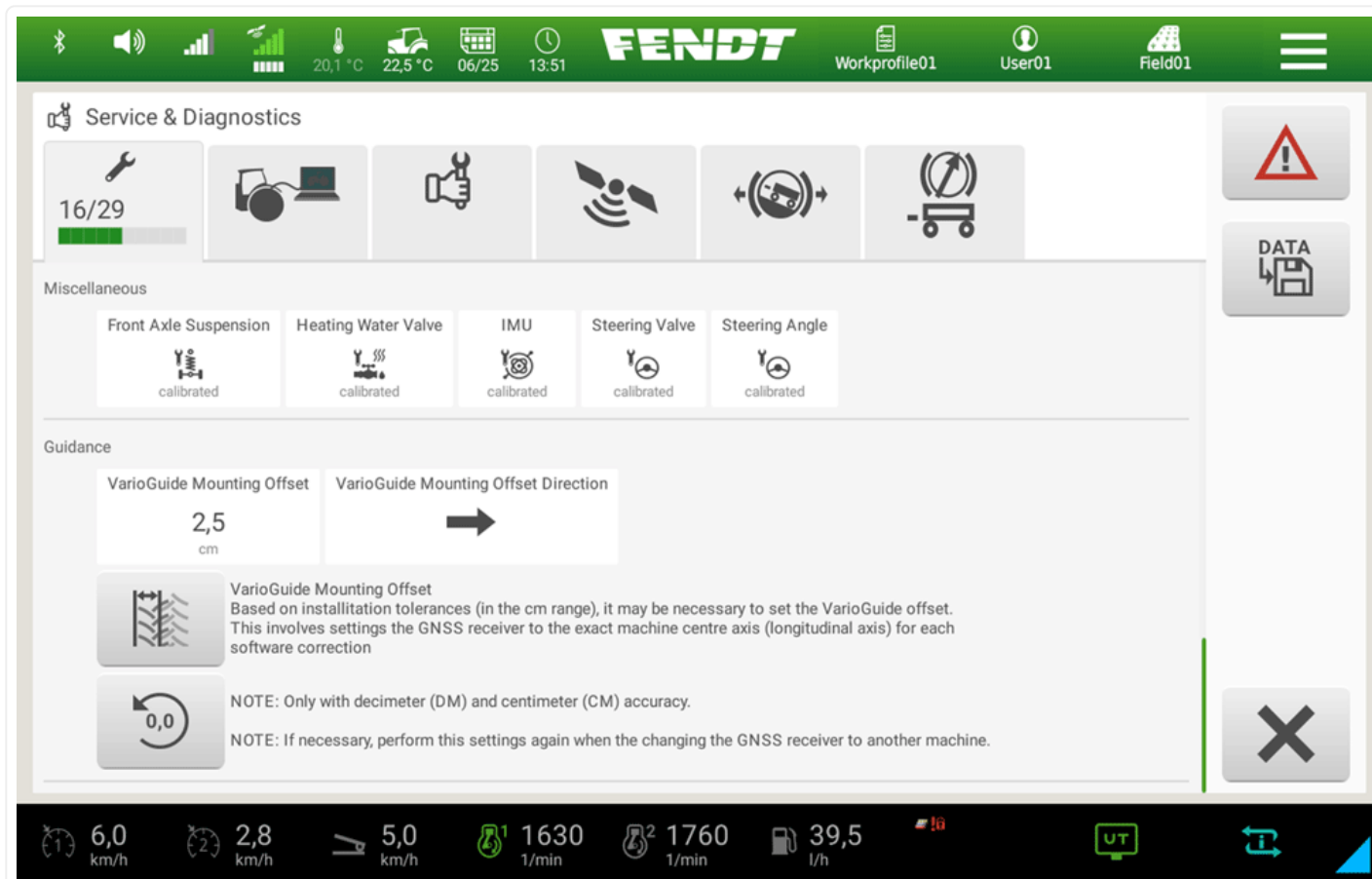

2. Scroll down  
Steering Angle

3. 
4. Start engine

5.  OFF

6.  **Warning:** Serious injury or death due to being in the steering system danger zone.  
Steering movements can cause bruising, shearing and impact injuries in the area of the steering angle.  
Ensure that there is nobody in the danger area.

**Note:** Provide that every prerequisite shown in the display is fulfilled.

start

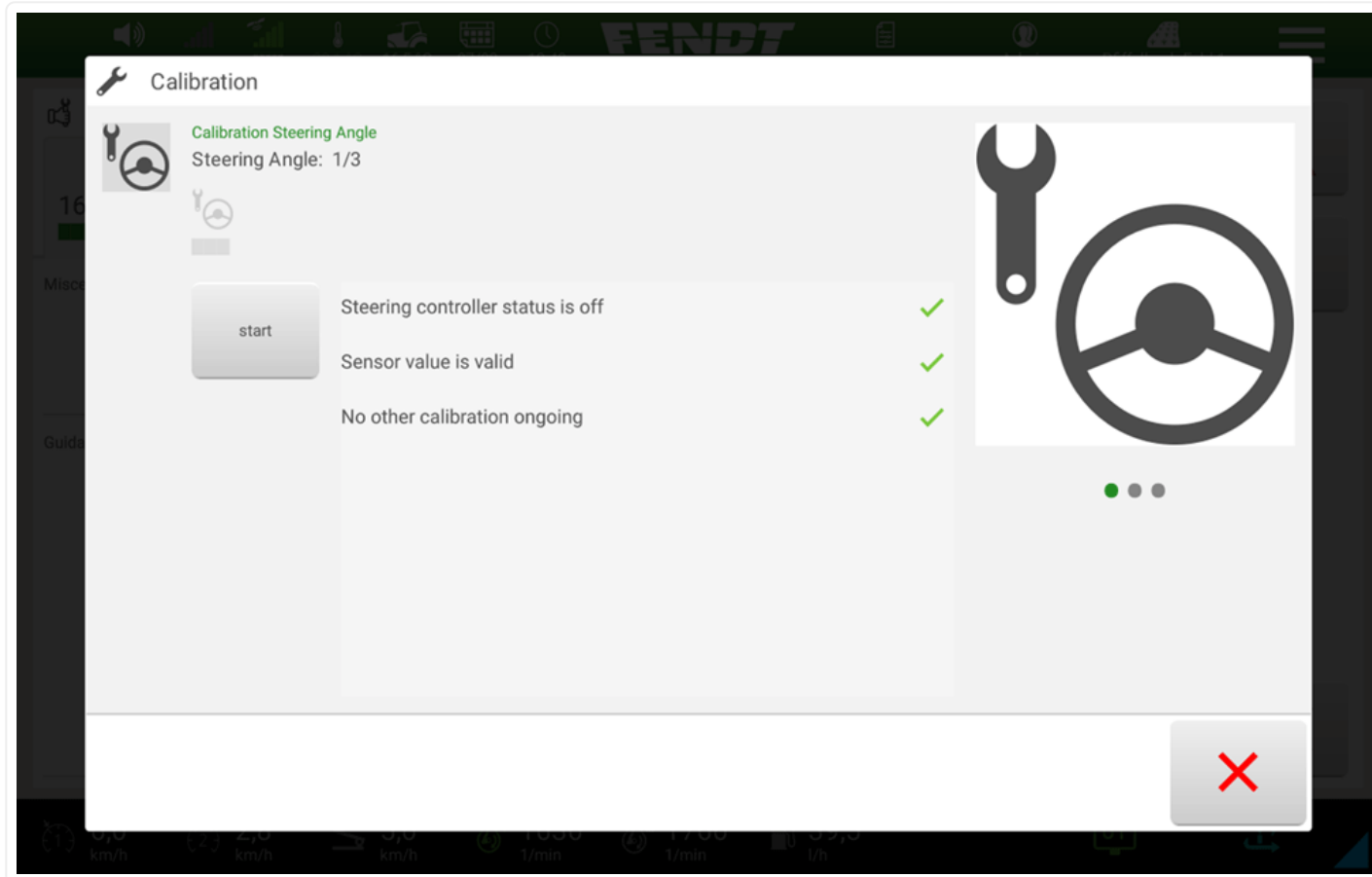

7. Proceed as follows:

**Note:**

- The values are not applied until after a key reset.
- Wait at least 60 seconds before switching the ignition ON.

## Feedback

21Views



Content valid only for 2021/9/28

2021 © AGCO CORPORATION